SPECIFICATION FOR APPROVAL

| | |
|-------------------|------------------|
| Product | DYNAMIC RECEIVER |
| Part No. | AR-1532D150-1W |
| Customer Approval | |

| Approved By | Checked By | Made By |
|-------------|------------|---------|
| | | |



A & B COMPONENTS

[HTTP://WWW.SPEAKER-TW.COM](http://www.speaker-tw.com)

1. SPECIFICATION

AR-1532D150-1W

| ITEMS. | | SPECIFICATIONS |
|--------|----------------------------|--|
| 01 | Type | Dynamic 15mm receiver unit |
| 02 | Sensitivity (S.P.L) | 91dB \pm 3 dB at 1kHz 100mV with IEC 318 coupler |
| 03 | Impedance. | 150 Ohm \pm 15% at 1KHz |
| 04 | Magnet Field Intensity. | Axial – dB , Radial –dB at 1KHz |
| 05 | Nominal Input Power | 30 mW |
| 06 | Max. Input Power. | 50 mW |
| 07 | Total Harmonics Distortion | Max 5 % at 1K Hz. |
| 08 | Operation temperature | -20°C to +60°C |
| 09 | Storage temperature | -30°C to +75°C |
| 10 | Weight. | 1.3g \pm 0.2g |

2. MEASURING METHOD

2-1. Test Condition

STANDARD

Temperature : 15 ~ 35°C

Relative humidity : 45% ~ 85%,

Atmospheric pressure : 860mbar to 1060mbar.

JUDGEMENT

Temperature : 20 \pm 3°C

Relative humidity : 60% ~ 70%,

Atmospheric pressure : 860mbar to 1060mbar

2-2. Standard Test Fixture

Input signal : 100mV

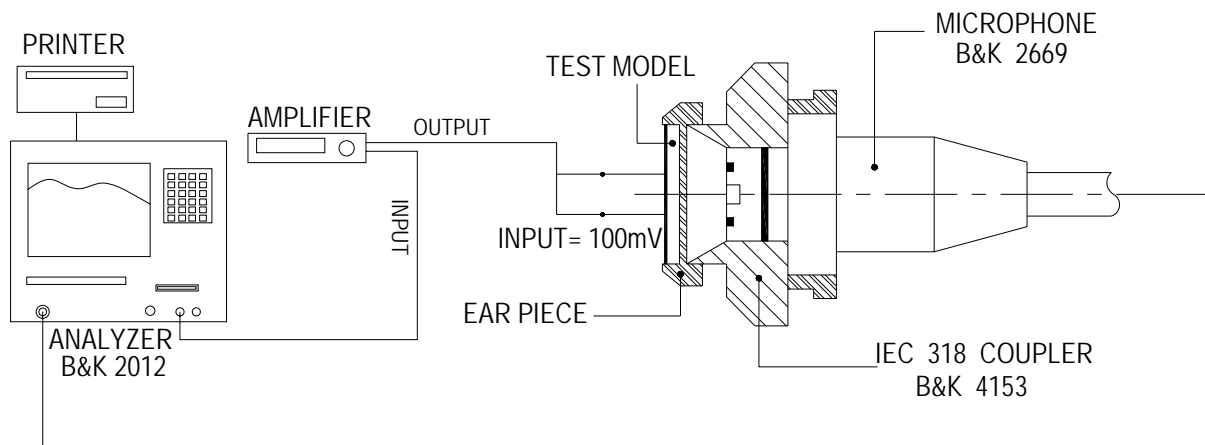

2.3 2Frequency Response Curve

AR-15150DA-1

X: 1.0000kHz Y: 92.18dB ZA: Live Curve SSR Fund.

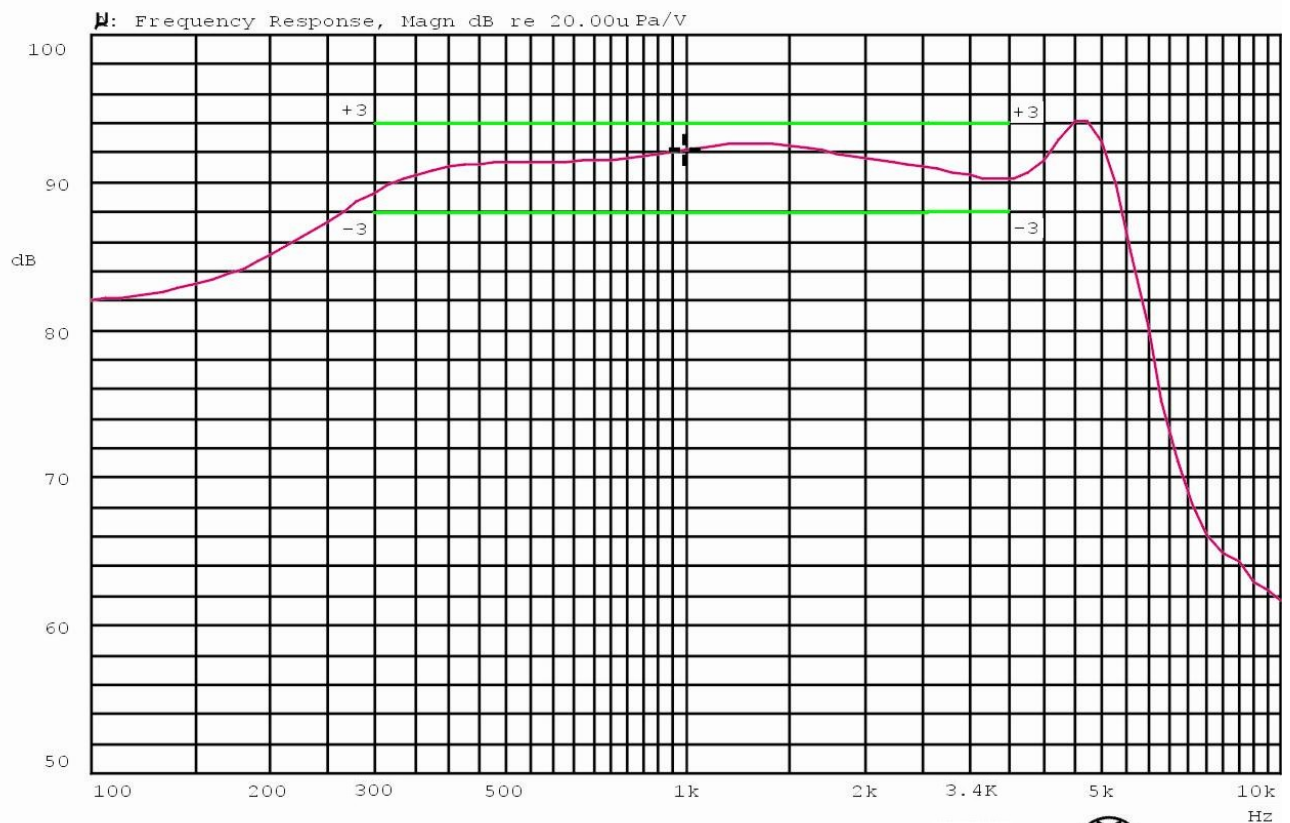

Mode: Receiver



REV NO.

REVISION NOTE

APPROVAL

DATE

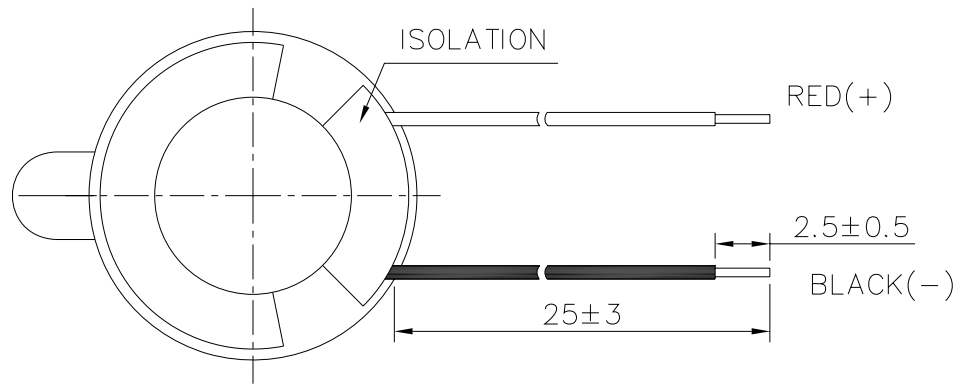

WIRE : UL1571 , AWG32 .

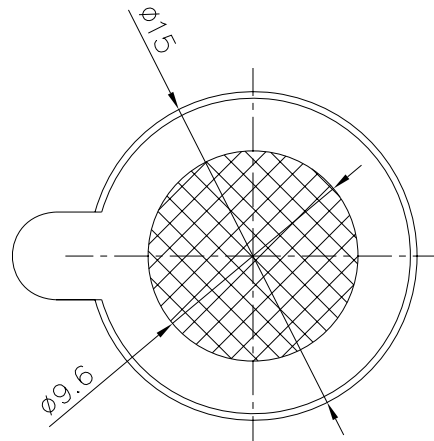
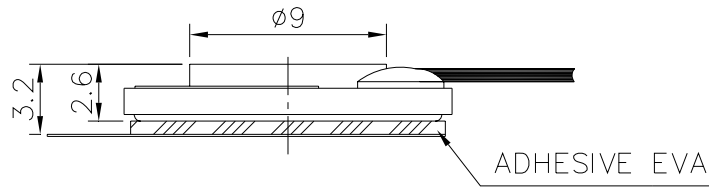

| | | | | |
|--------------------------------|--|----------------------------------|-----------------------------|---------------|
| TITLE: <i>DYNAMIC RECEIVER</i> | | DRAWN: <i>Richard</i> 10/25/2005 | SCALE: 3:1 | SHEET: 1 of 1 |
| PART NO. <i>AR-1532D150-1W</i> | | DESIGNED: <i>R & D DEP.</i> | UNITS: <i>mm</i> | |
| DWG NO. <i>DTR-1085</i> | | CHECKED: | TOLERANCE ± 0.2 | |
| | | APPROVAL: | UNLESS OTHERWISE SPECIFIED: | |
| REV | | MATERIAL: <i>*****</i> | ONE PLACE DECIMAL ± *** | |
| | | | TWO PLACE DECIMAL ± *** | |
| | | | THREE PLACE DECIMAL ± *** | |

A & B Components

4. RELIABILITY TESTS

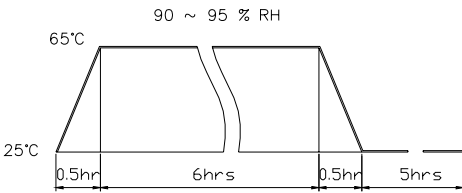
| ITEMS. | | SPECIFICATIONS |
|---|----------------------|---|
| 01 | High temp. Test | Keep 96 hours at $+85^{\circ}\text{C} \pm 3^{\circ}\text{C}$ and leave 3 hours in normal temperature and then check |
| 02 | Low temp. Test | Keep 96 hours at $-30^{\circ}\text{C} \pm 3^{\circ}\text{C}$ and leave 3 hours in normal temperature and then check |
| 03 | Humidity test | Keep 96 hours at $+40^{\circ}\text{C} \pm 3^{\circ}\text{C}$ relative humidity 90% and leave 3 hours in normal temperature and then checked. |
| 04 | Temp./humidity cycle | <p>The part shall be subjected 5 cycles. One cycle shall be 12 hours and consist of;</p>  <p style="text-align: center;"> 65°C $90 \sim 95 \% \text{ RH}$ 25°C 0.5hr 6hrs 0.5hr 5hrs </p> |
| 05 | Thermal Cycle Test. | Low temperature: $-30^{\circ}\text{C} \pm 3^{\circ}\text{C}$, temperature: $+85^{\circ}\text{C} \pm 3^{\circ}\text{C}$, cycle: 1 hour/cycle each, and then keep 5 cycles in a room. |
| 06 | Vibration | 10~200~10Hz Sin-Wave Sweep 15min. 5G(Constant) X,Y, Z 3 direction. 2 hours each, total 6 hours. |
| 07 | Fix Drop test | Fix on Jig. then drop from 152cm height to the concrete floor X,Y, Z 6 direction. 5 times each, total 30 times. |
| 08 | Free Drop test | Free drop from 100cm height to the concrete floor X,y, z 6 direction. 1 times each, total 6 times. |
| 09 | Load test | Rated power white noise is applied for 96 hours |
| 10 | Max Power test | Max Power 1 minute on – 2 minute off 10 cycles. |
| <p>Criterion :</p> <p>After these test , the change of S.P.L shall be within $\pm 3 \text{ dB}$.</p> | | |